

<u>Rating</u>	<u>Time</u>	<u>Name</u>		<u>Event #</u>	<u>Event</u>	<u>Group</u>	<u>List #</u>	<u>Wm Up</u>	<u>Perform</u>
Orchestra									
<u>Rating</u>	<u>Time</u>	<u>Name</u>		<u>Event #</u>	<u>Type</u>	<u>Group</u>	<u>List #</u>	<u>Wm Up</u>	<u>Perform</u>
	8:52	Kessler	Jaden	123	BAX1	3		111	114
	9:04	Kpedi	Samara	123	BAX1	1	500	111	114
	9:06	Dorsey	Emmalee	120	VNX1	2		221	220
	9:30	Sherling	Kaitlin	120	VNX1	2		221	220
	9:56	Brown	Zane	121	VAX1	1	091	111	115
	9:58	Valdiva	Reina	122	CEX1	4		111	114
	10:12	Coleman	Zoe	120	VNX1	1	500	221	220
	10:40	DORSEY		131	STRx3	1	021	111	115
	10:46	Dollar	Caitlyn	120	VNX1	1	197	221	220
	10:49	Eshleman	Kylee	122	CEX1	3		111	114
	11:10	Eshleman	Kylee	120	VNX1		500	221	220
	11:34	Greiwe	Cora	120	VNX1	1	219	221	220
	11:37	Patterson	Azure	122	CEX1	3		111	114
	11:52	Miller	Jessie	120	VNX1	1	007	221	220
	12:16	Mimms	Adia	120	VNX1	1	127	221	220
	12:19	KHAN		136	STRx4	3		111	115
	12:25	Rigdon	Jenna	122	CEX1	2		111	114
	1:31	GREIWE		136	STRx4	2		111	115
	1:37	Gilbert	Duranda	122	CEX1	1	117	111	114
	1:47	FLORES		138	M STRx4	3		111	115
	2:01	Schneider	Mark	122	CEX1	1	500	111	114
	2:15	ESHLEMAN		130	VNX3	3		221	220
	2:26	MEJIA		140	STRx5	3		111	115
	2:32	MIMMS		140	STRx5	1	028	111	115

Band									
Rating	Time	Name		Event #	Event	Group	List #	Wm Up	Perform
	8:54	SHERLING		027	Saxx3	2		212	210
	8:54	HAYNES		031	CLx4	1	037	202	203
	9:00	ROSTRON Q		027	Saxx3	1	040	212	210
	9:06	ROSTRON C		027	Saxx3	1	042	212	210
	9:12	HERON		025	FLx3	2		100	105
	9:15	PATTERSON		110	PCx3	3		Gym	Load
	9:18	RAMSEY		035	WWx4	1	021	100	105
	9:30	HOWARD		032	Saxx4	1	052	212	210
	9:41	Patterson	Azure	102	Snarex1	3		Gym	124
	9:42	Newman	Rhiannon	001	Picx1	2		100	109
	9:48	Schneider	Sarah	002	FLx1	3		100	109
	10:00	Jones	Makenzie	050	TPx1	1	038	212	216
	10:06	Schoenling	Drew	012	ASx1	2		212	210
	10:07	Schneider	Mark	056	EUx1	4		100	104
	10:25	Warnke	Anna	052	FHx1	1	097	221	217
	10:30	Jansen	Caleb	100	Marimx1	1	003	Gym	Load
	10:34	Kinslow	Joseph	050	TPx1	1	052	212	216
	10:50	Patterson	Azure	099	Drumsetx1	1	099	Gym	125
	10:58	Kretler	Matthew	050	TPx1	1	052	212	216
	11:01	Haynie	Emelyn	052	FHx1	1	072	221	217
	11:04	Howard	James	012	ASx1	1	023	212	210
	11:16	Sego	Robin	050	TPx1	3		212	121
	11:18	Britton	Khloe	100	Marimx1	1	009	Gym	Load
	11:28	Wilson	Cameron	050	TPx1	1	012	212	216
	11:40	Risser	Jameson	012	ASx1	1	070	212	210
	12:52	Allison	Patrick	050	TPx1	1	025	212	216
	12:58	Newman	Rhiannon	002	FLx1	2		100	109
	1:10	Rostron	Cameron	012	ASx1	1	105	212	210
	1:16	Grese	Joseph	050	TPx1	1	067	212	216
	1:17	JACKSON		081	M Brassx5	2		100	104
	1:18	Harper	Joseph	100	Marimx1	1	009	Gym	Load
	1:22	Jones	Shayla	002	FLx1	1	026	100	109
	1:22	Greenburg	Abby	008	CLx1	1	111	202	203
	1:34	Rostron	Quinten	012	ASx1	1	070	212	210
	1:46	Ramsey	Ann	002	FLx1	1	095	100	109
	1:46	Hayes	Erika	008	CLx1	1	076	202	203
	1:49	Jackson	Eli	054	TBx1	1	076	202	108
	1:53	TAYLOR		065	TPx3	2		212	216
	2:04	Pugh	Yasmen	002	FLx1	1	006	100	109
	2:08	WILSON		080	Brassx5	1	026	100	104
	2:19	Sherling	Kaitlyn	013	TSx1	2		202	206
	2:22	Burgin	Katie	002	FLx1	1	157	100	109
	2:22	Haynes	Kiara	008	CLx1	1	097	202	203
	2:50	Gilbert	Nyla	013	TSx1	1	500	212	210
	2:56	Cross	Kenadie	002	FLx1	1	056	100	109
	2:56	Rimmert	Ashley	008	CLx1	1	133	202	203
	3:14	Greiwe	Ella	002	FLx1	1	085	100	109
	3:20	Cheatams-Hani	Jalen	008	CLx1	1	500	202	203

DISTRICT SOLO & ENSEMBLE COMPETITION 2018

Lawrence North High School Band and Orchestra

- DATE:** Saturday, January 27, 2018
- WHERE:** Doe Creek Middle School, located at 5613 W 200 S., New Palestine, IN 46163, between US 40 and US 52.
- PARKING:** The best location to park will be on the South side of the building and enter through **door #9**. Additional parking is available at the "old" Doe Creek building located on the Southwest side of the school.
If there is a cancellation due to severe weather, an announcement will be made on WTHR Channel 13 on January 27.
- ARRIVAL:** Plan to arrive at least **30 minutes prior** to scheduled performance time. Solo and Ensemble performance schedules are affected by many variables. Students may not perform at the exact time as scheduled. **Please be patient.**
- MUSIC:** Students should provide music to the adjudicator. All of the performance measures must be numbered. Ensembles should have a group leader responsible for this activity. After their performance, students should retrieve the music that was used by the adjudicator and a voucher card indicating the rating received from the Door Monitor of the performance room.
- MEDALS:** The voucher card should be presented to the "Medal Table" at the performance site the day of performance to receive the appropriate award for performance.
- ETIQUETTE:** Do not interrupt a performance once it has begun. Door Monitors assist the performance room in avoiding interruptions. Please be respectful of these volunteer workers. Please remember to **turn off all cell phones and pagers** prior to entering the performance area. Performance rooms and hall areas should be kept as quiet and accessible as possible. Please assist in keeping the noise level to a minimum, especially outside of performance rooms.
- FOOD:** There will be food available at the performance site. Please be sure to keep all food and drink in the designated area and out of the warm-up and performance rooms.
- ADJUDICATOR SHEET:** This will only be made available to your Music Director or designated replacement at the end of the performance day.
- STATE:** A Gold Rating on Group I events is eligible to perform at the State Level. **Eligible students will be automatically entered, unless they have told their director they do not wish to participate** at state. The band or orchestra will pay for entry fees. If a student chooses to not participate after the entry fee has been paid, the student will be charged. State Solo & Ensemble is February 24, 2018.
- APPEARANCE:** Your appearance is important, DRESS TO IMPRESS!
- PERCUSSION EQUIPMENT:** Students are responsible for bringing their own mallets and any other percussion equipment needed. The following equipment will be provided: Concert Bass Drum, Timpani 23", 26", 29", 32", 4 1/3 Octave Marimba, Xylophone, Chimes.

If you should have any further questions, please contact your student's school music director for clarification.



5613 West 200 South
New Palestine, IN 46163
Phone: 317-861-4487 Fax: 317-861-2136

Driving Directions

From I-70 East or West
Take exit 96 from I-70
Go South on 600 W
Turn left onto 200 S

From I-465
Take exit 47 for US 52
E/Brookville Rd
Turn left onto S 600 W
Turn right onto W 200S

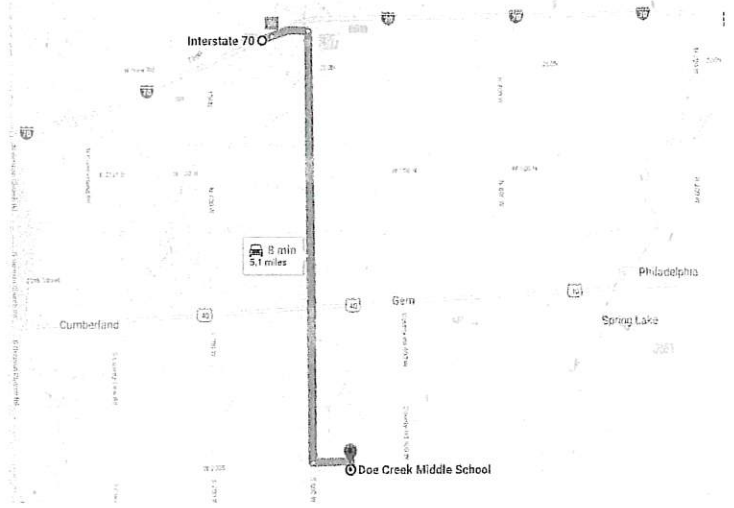
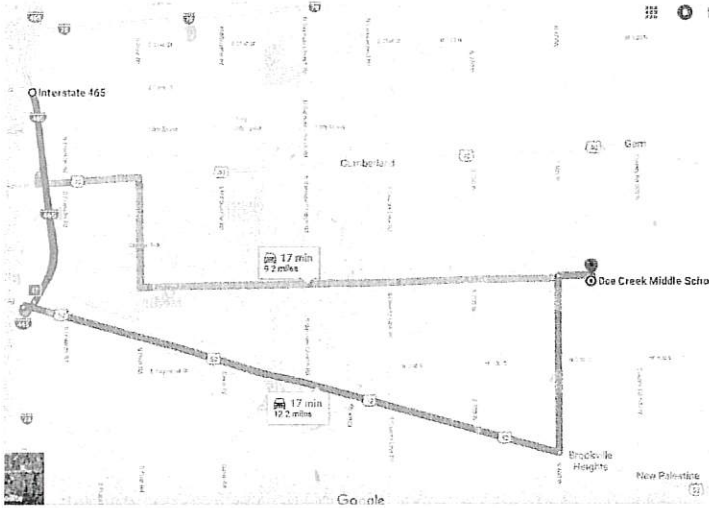

DOE CREEK

1st Floor

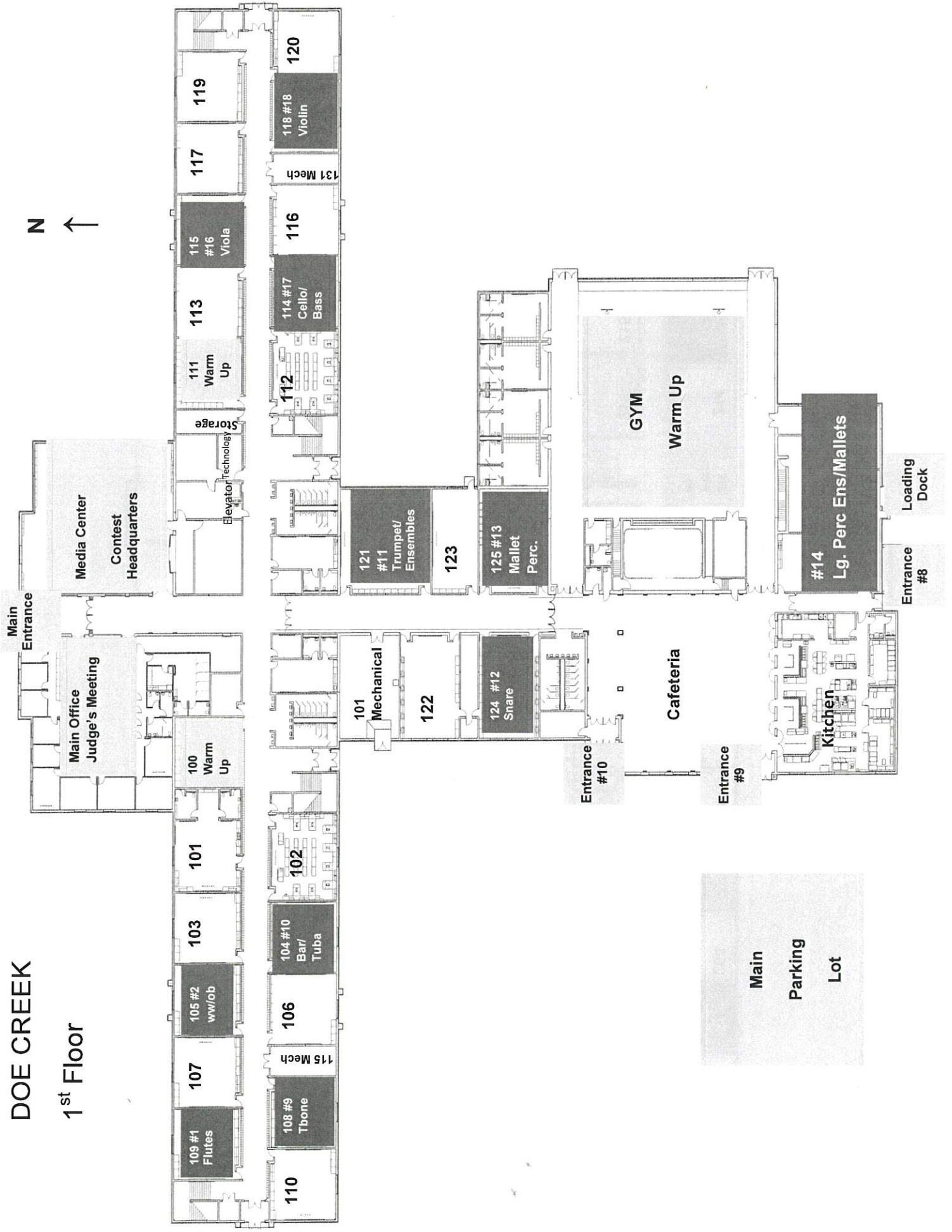

Main
Parking
Lot

Doe Creek

2nd Floor

